

Considerations before installation

- The polythene shrink wrap or foil is an integral part of the product, please ensure it is still in place following installation.
- If insulation is installed, remove the insulation layer at the point where the barrier is to be installed.
- Ensure the correct size barrier is installed to suit the cavity width, allowing for the required air gap and specified fire performance.
- Ensure the intumescent strip faces out towards the external facade.
- When fixing into Siniat Weather Defence board, the fixings (supplied by others) must penetrate the depth of the board so they are fixed back into the framework behind.
- When fixing to masonry, the fixings (supplied by others) should be of an appropriate type and length for the surface the brackets are being fixed to.
- When fixing into other surfaces, the fixings (supplied by others) should be of an appropriate type and length for the surface the open state cavity barrier is being fixed to.
- The substrates the barriers have been tested with can be found on page 6 of the Technical Data Sheet.
- Please consult a fixings manufacturer for the correct fixings for the substrate.
- Seal any gaps up to 5mm wide with PFC Corofil Acoustic Intumescent Sealant to a minimum depth of 10mm.
- For lengths shorter than 1 metre reduce the fixing centres to accommodate the required number of fixings/brackets at an equal distance apart. For lengths 200mm long or less, install one fixing/bracket centrally.
- When cutting Open State Barrier (COSB) to short lengths, ensure the polythene shrink wrap/foil is reinstated.
- Ensure the intumescent is free to expand across the air gap to the back of the external wall leaf in a fire situation.

Direct fixings

Mechanically fix the COSB back to the inner substrate using 4 fixings (supplied by others - see fixings table on page 5 of Technical Data Sheet) along the central line of the barrier. Ensure the head of the screw does not penetrate the intumescent part of the barrier. The screw head must not exceed 11mm in diameter.

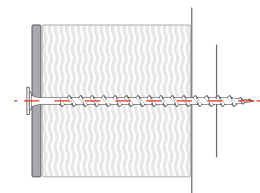

Ensure that adjacent lengths have their joints tightly abutted together and are aligned flush with each other to create the appearance of a continuous barrier.

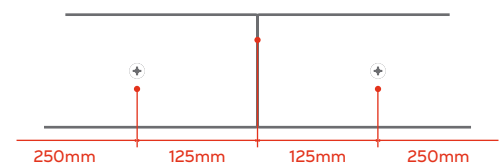

COSB25

Fixings with brackets

Mechanically fix the brackets (see fixings table on page 5 of Technical Datasheet for quantity and type of bracket) to the substrate using the appropriate non-combustible corrosion resistant fixings (supplied by others) per bracket.

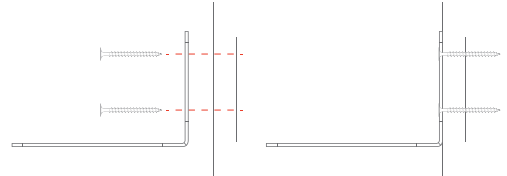

Spike the COSB onto the brackets centrally along the length of the barrier.

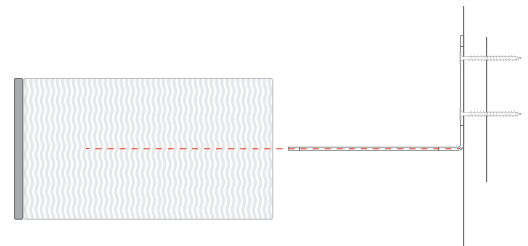

Ensure that adjacent lengths have their joints tightly abutted together and are aligned flush with each other to create the appearance of a continuous barrier.



Where required, fix the 65mm long pigtail screws 125mm in from one end of the barrier and at 250mm centres along the centre line of the barrier so the head of the pigtail screw (see table on page 5 of Technical Data Sheet for barriers requiring pigtail screws) protrudes across the cavity to maintain the 25mm free air gap.

